

AREA STATEMENT
 TOTAL PLOT AREA = 59.37 Ha
 10% OPEN SPACE = 5937.0 SQMT
 TOTAL PROPOSED AREA

APPROVED STRUCTURES	GROUND FLOOR AREA IN SQMT	FIRST FLOOR AREA IN SQMT	SECOND FLOOR AREA IN SQMT	TOTAL AREA IN SQMT
1 REGIONAL CENTRE	1886.3103	663.5955	---	2549.9058
2 ACADEMIC	3000.0000	---	---	3000.0000
3 COMMUNICATION	3000.0000	---	---	3000.0000
4 MAIN BUILDING	2136.63	1591.63	---	3728.26
5 GUEST HOUSE	393.389	756.978	---	1150.367
6 LIBRARY & COMPUTER	900.0000	900.0000	---	1800.0000
7 DORMITORY	300.0000	---	---	300.0000
8 POST OFFICE	300.0000	---	---	300.0000
9 SHOPPING	400.0000	---	---	400.0000
10 SCHOOL	500.0000	500.0000	---	1000.0000
11 DISPENSARY	400.0000	---	---	400.0000
12 Y B MEMORIAL	75.0000	125.0000	75.0000	275.0000
13 TRANSIT ACCOMODATION	310.2320	292.790	132.87468 (b)1	782.692
14 ESTATES	200.0000	---	---	200.0000
15 DESPATCH	1000.0000	---	---	1000.0000
16 OPEN AIR THEATRE	950.0000	---	---	950.0000
17 CLASS FOUR HOUSING	511.1538	---	---	511.1538
18 WELFARE SEMINAR HALLS CONVOCAT HALLS	2000.0000	---	---	2000.0000
19 VCS BUNGALOW	100.0000	50.0000	---	150.0000
20 HOUSING 100 M ²	2600.0000	---	---	2600.0000
21 HOUSING 75 M ²	1800.0000	1800.0000	---	3600.0000
22 CAFETERIA/RECREATION TOL BLOCK	520.30	340.07	---	870.56
TOTAL AREA	23279.051	7084.063	204.6700	30567.938

TOTAL PLINTH AREA = 23279.051
 TOTAL B/UP AREA = 30567.938

EXISTING STRUCTURES	GROUND FLOOR AREA IN SQMT	FIRST FLOOR AREA IN SQMT	SECOND FLOOR AREA IN SQMT	TOTAL AREA IN SQMT
1 MAIN BUILDING	2136.63	1591.63	---	3728.26
2 GUEST HOUSE	393.389	756.978	---	1150.367
3 CAFETERIA/RECREATION TOL BLOCK	520.30	340.07	---	870.56
4 CLASS FOUR HOUSING	511.1538	---	---	511.1538
5 TRANSIT ACCOMODATION	310.2320	292.790	132.87468 (b)1	782.692
6 ACADEMIC	3000.0000	---	---	3000.0000
TOTAL AREA	6917.8948	3081.468	132.87468 (b)1	10143.0328

TOTAL PLINTH AREA IN PHASE I = 6917.8948 Sqmt
 TOTAL B/UP AREA IN PHASE I = 10143.0328
 AREA UNDER ROAD
 10% OPEN AREA
 B/UP AREA PERMISSIBLE = 58776.30

LAY OUT OF OPEN UNIVERSITY AT NASHIK IN G. NO. 48 AT VILLAGE GOVARDHAN FOR YESHWANTRAO CHAVAN MAHARASHTRA OPEN UNIVERSITY.

NEW STRUCTURES	GROUND FLOOR AREA IN SQMT	FIRST FLOOR AREA IN SQMT	TOTAL AREA IN SQMT
23 FARM & PACKING SHED	149.776	---	149.776
24 ENCLOSING SITOUT AREA OF TOILET BLOCK OF GUEST HOUSE	15.89	---	15.89
25 CAR PARKING SHED (INFRONT OF WARE HOUSE)	213.20	---	213.20
26 PUMP HOUSE OF K.V.K	15.65	---	15.65
27 ADMINISTRATIVE BLDG. OF K.V.K.	686.26	691.66 + 300.00	1377.92
28 HOSTEL BLDG. OF K.V.K. (GODAVARI HOUSE)	323.965	313.219	637.184
29 GENERATOR HOUSE (Near Main Bldg.)	69.963	---	69.963
30 GENERATOR HOUSE (Near Guest House)	60.58	---	60.58
31 GENERATOR HOUSE (Near Guest House)	60.58	---	60.58
32 Spawn Product LABS OF K.V.K.	30.17	---	30.17
TOTAL AREA	1828.93	1034.84	2863.77

Registar
 Yeswantrao Chavan Maharashtra Open University, Nashik-422 002

SHIVAJI H. KNODE
 CONSULTING ENGINEER & VALUER'S
 OFFICE: NO. 3 BUILDING NO. 429, STATION COMPLEX
 M.G. ROAD, NASHIK - 422 001 'B' ST/807

JOB NO. 345 DRG NO. 87 SCALE 1:1250
 DATE 27-11-2021 DRAWN BY: CHECKED BY:

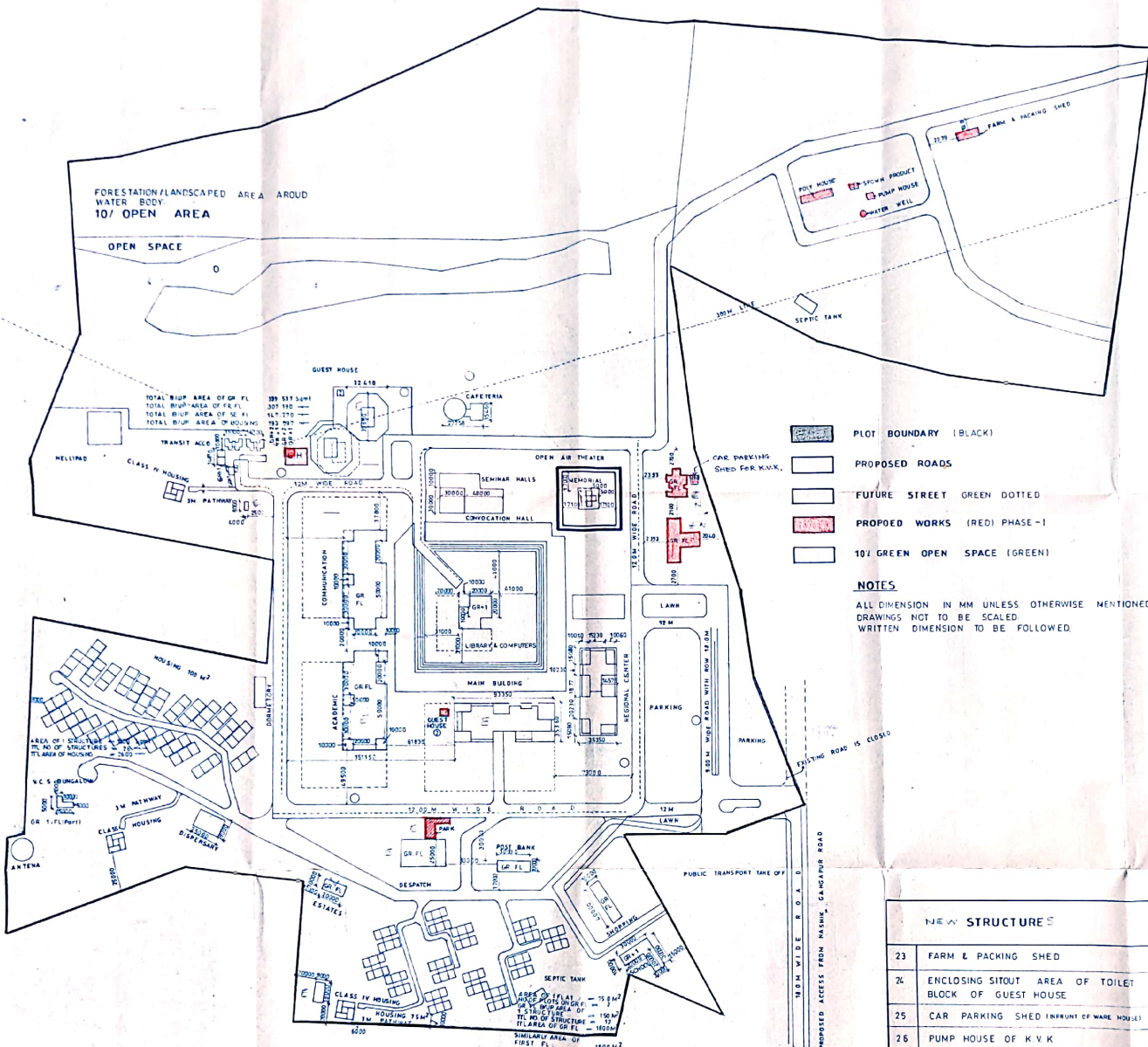

श्री. शिवजी
 शिवजी एच. कनोडे
 शिवजी एच. कनोडे

श्री. शिवजी
 शिवजी एच. कनोडे
 शिवजी एच. कनोडे